

force[⚡] smart door automation

force[⚡]

smart door automation

powered by **flexiforce^{FF}**

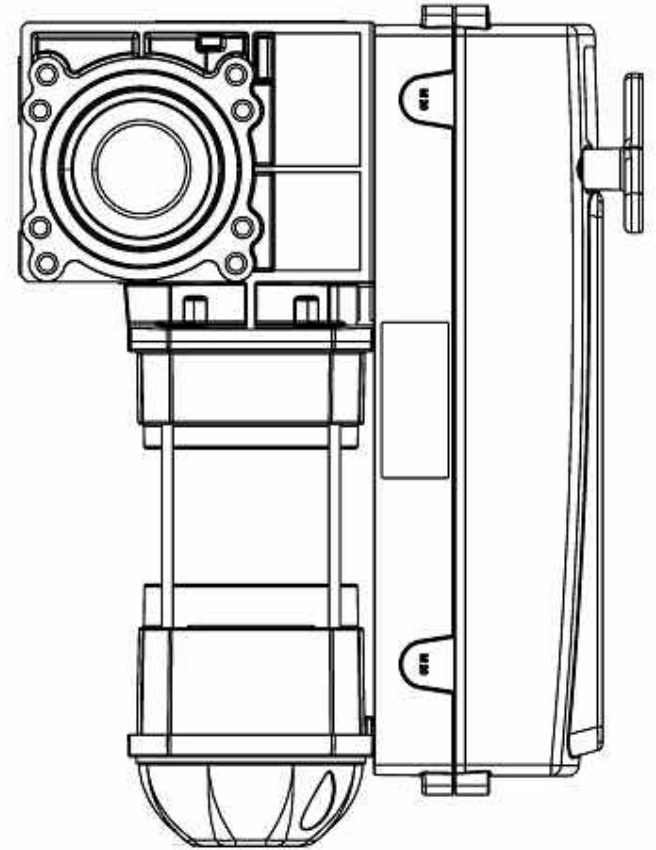

Start programming



6 SECONDS

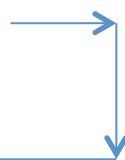

Scrolling through main menu using:

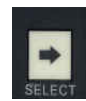

(DETAILS ON PAGE 4-6)

- LANGUAGE** CHANGE LANGUAGE TO YOUR PREFERRED OPTION (DETAILS ON PAGE 7)
- MOTOR SETUP** PROGRAM: MOTOR DIRECTION, ENCODER DIRECTION, TYPE OF ENCODER/ENDSWITCH (DETAILS PAGE 9,15)
- ADJUST ENDPOS.** ADJUST ENDPOSITIONS: TOP , BOTTOM, PRE-END AND SAFETY-ENDSWITCH (DETAILS PAGE 8)
- SAFETY DEVICES** PROGRAM: 4 WIRE PHOTOCCEL, LIGHT CURTAIN, OPTOSENSORS, AIRSWITCHES (DETAILS PAGE 10,11,12,13,14)
- OPERATING MODE** PROGRAM: AUTOMATIC OPEN/CLOSE, DEADMANOPEN/CLOSE, AUTOMATIC OPEN DEADMAN CLOSE (DETAILS PAGE 15)
- CODE ENTRY** CHANGE ENTRY CODE (DETAILS PAGE 16) AFTER CHANGING ALWAYS START PROGRAMMING WITH ENTERING CODE
- SPECIAL SETUP** PROGRAM: AUTOMATIC CLOSE, PARTIAL OPEN, RELAYS 1, 2 AND 3 , (DETAILS PAGE 17,18)
- SERVICE** PROGRAM: CYCLES AND/OR DAYS TO SERVICE, SET CLOCK, READ FAULTS, RESET FAULTS(Details PAGE 20,21)



USE THIS BUTTON TO SCROLL THROUGH THE MENU (PREVIOUS CHOICE SAME LEVEL)



**USE THIS BUTTON TO MOVE 1 STEP HIGH UP IN THE MENU, OR TO CHANGE THE VALUE IN THE DISPLAY (1 UP)
USE THIS BUTTON TO STEP OUT OF MAIN MENU TO NORMAL OPERATING STATUS OF MOTOR**

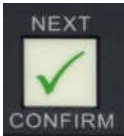

USE THIS BUTTON TO CONFIRM THAT YOU WANT TO CHANGE WHAT IS IN THE DISPLAY, OR TO CONFIRM A CHANGE



USE THIS BUTTON TO CHANGE THE VALUE IN THE DISPLAY (1 DOWN)

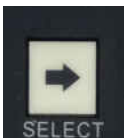

USE THIS BUTTON TO SCROLL THROUGH THE MENU (NEXT CHOICE SAME LEVEL)

ENTER PROGRAMMING



6 SECONDS



NAVIGATING MAIN MENU



GOTO MENU LANGUAGE



GOTO MENU MOTOR SETUP



GOTO MENU ADJUST
ENDPOSITIONS



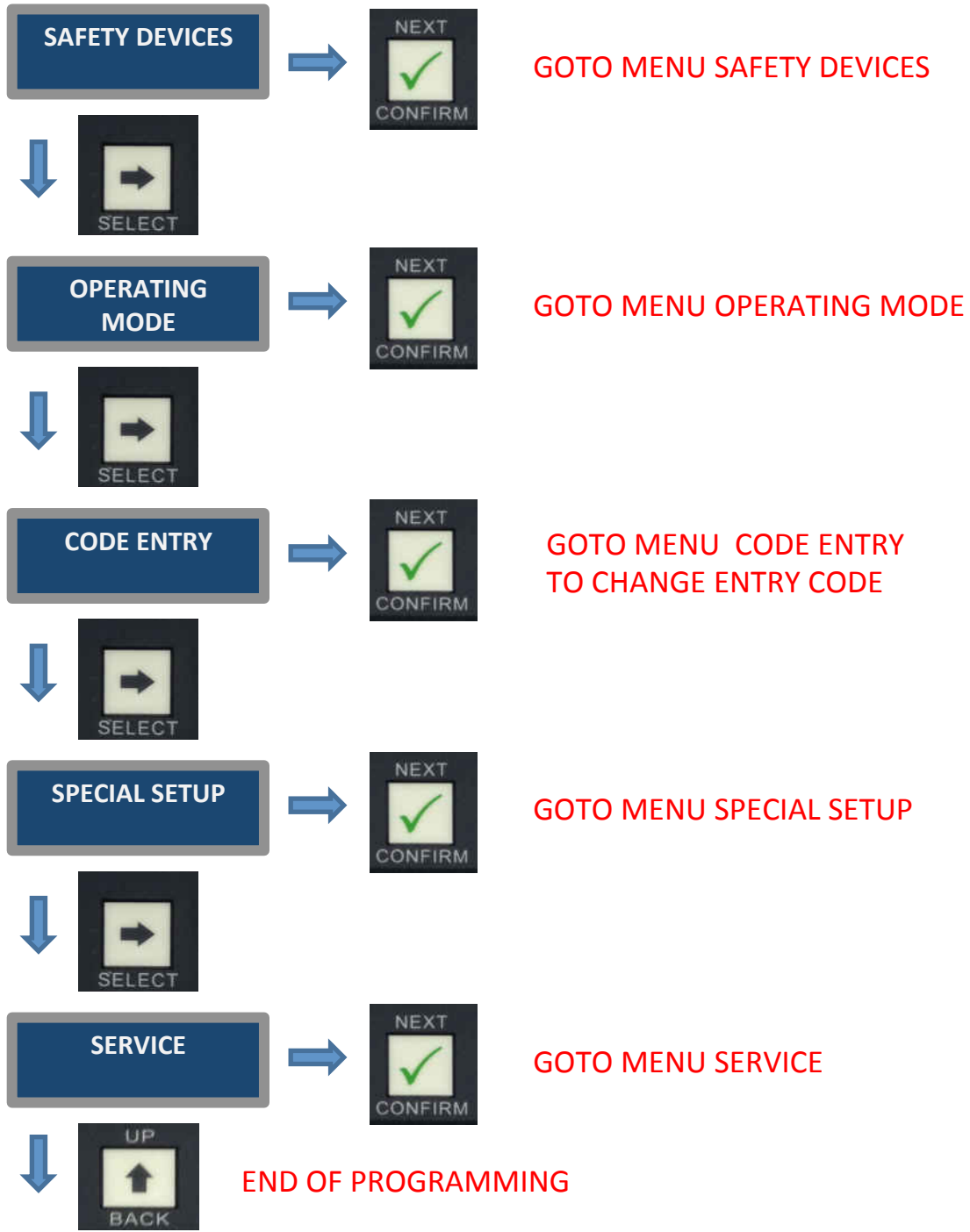

MENU LANGUAGE

LANGUAGE



LANGUAGE
ENGLISH



CONFIRM LANGUAGE
GO BACK TO MAIN MENU



LANGUAGE
ITALIANO

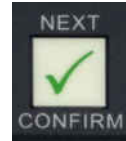

CONFIRM LANGUAGE
GO BACK TO MAIN MENU



PRESS SELECT AGAIN UNTIL
DESIRED LANGUAGE

LANGUAGE
DEUTSCH



CONFIRM LANGUAGE
GO BACK TO MAIN MENU

MENU ADJUSTING ENDPOSITIONS

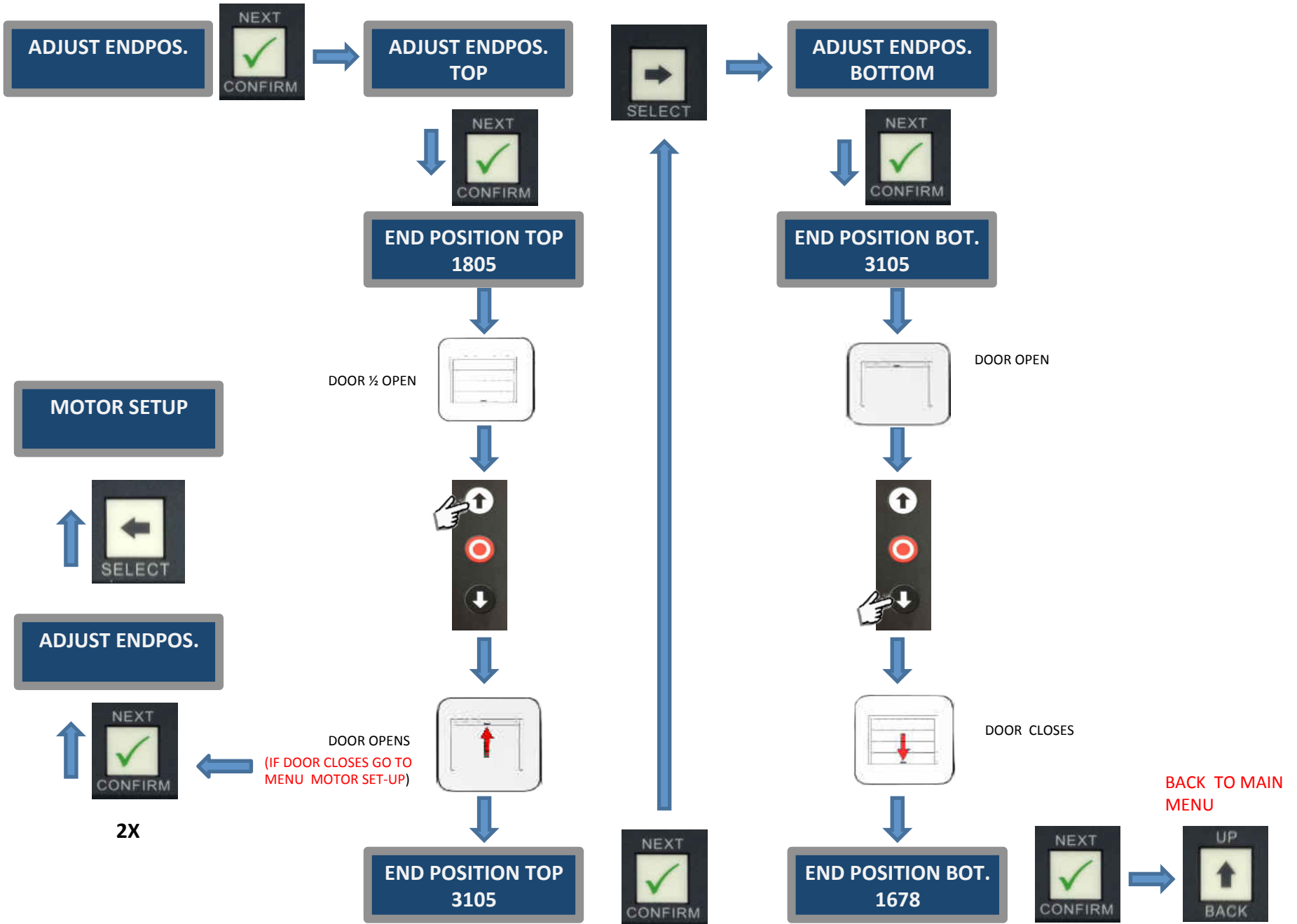

MENU MOTOR SETUP/ CHANGE MOTOR DIRECTION

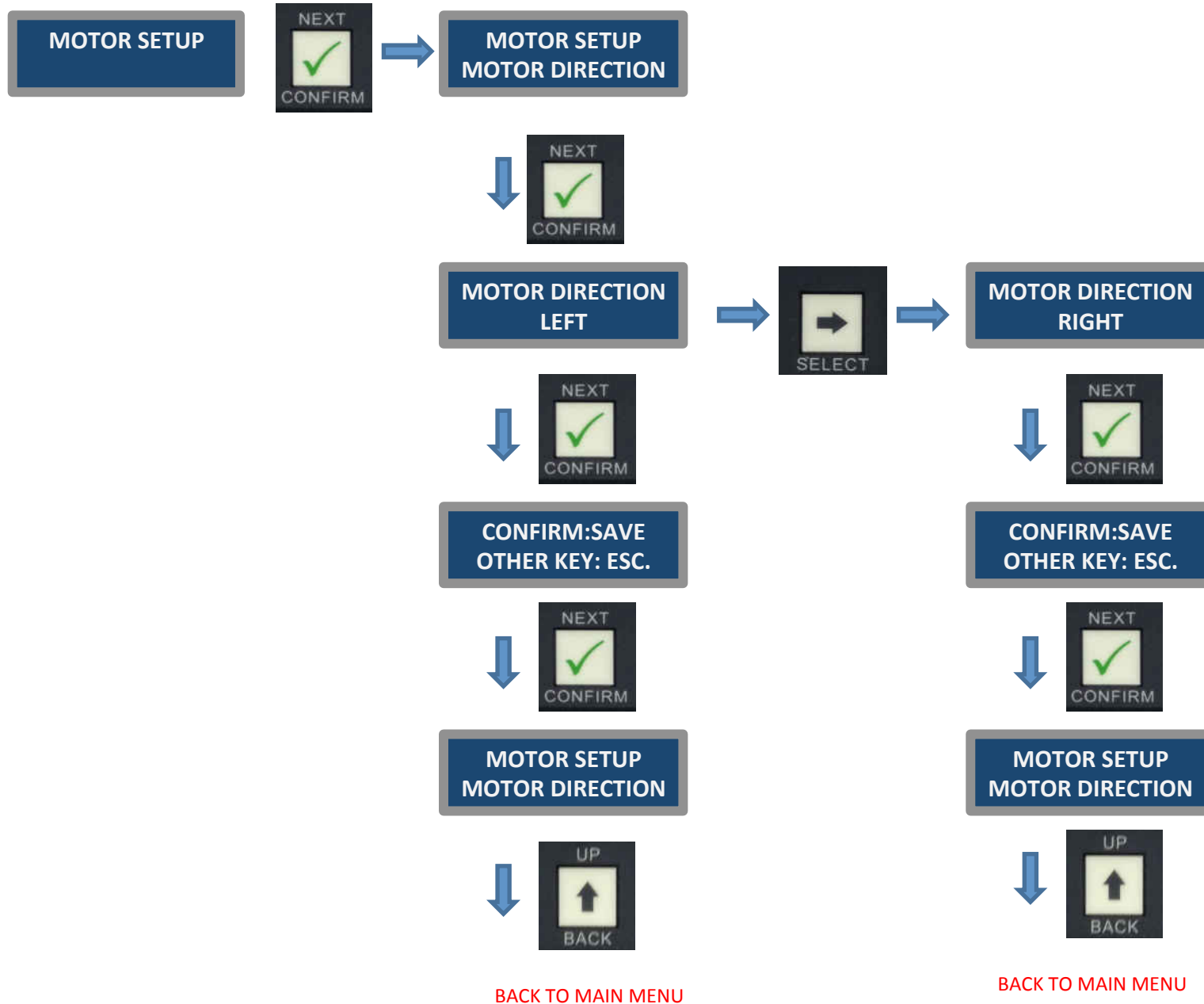

MENU SAFETY EDGE WITH OPTO SENSOR :OSE

SAFETY DEVICES



4-WIRE PHOTO KL5
DISABLED



2-WIRE PHOTO KL6
DISABLED



OSE1 SETUP KL3
DISABLED

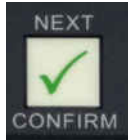

CONNECTED
DISABLED



CONNECTED
OSE

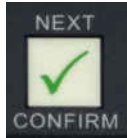

CONNECTED
DOWN FULL REVERS



OSE2 SETUP
DISABLED



BACK TO MAIN MENU

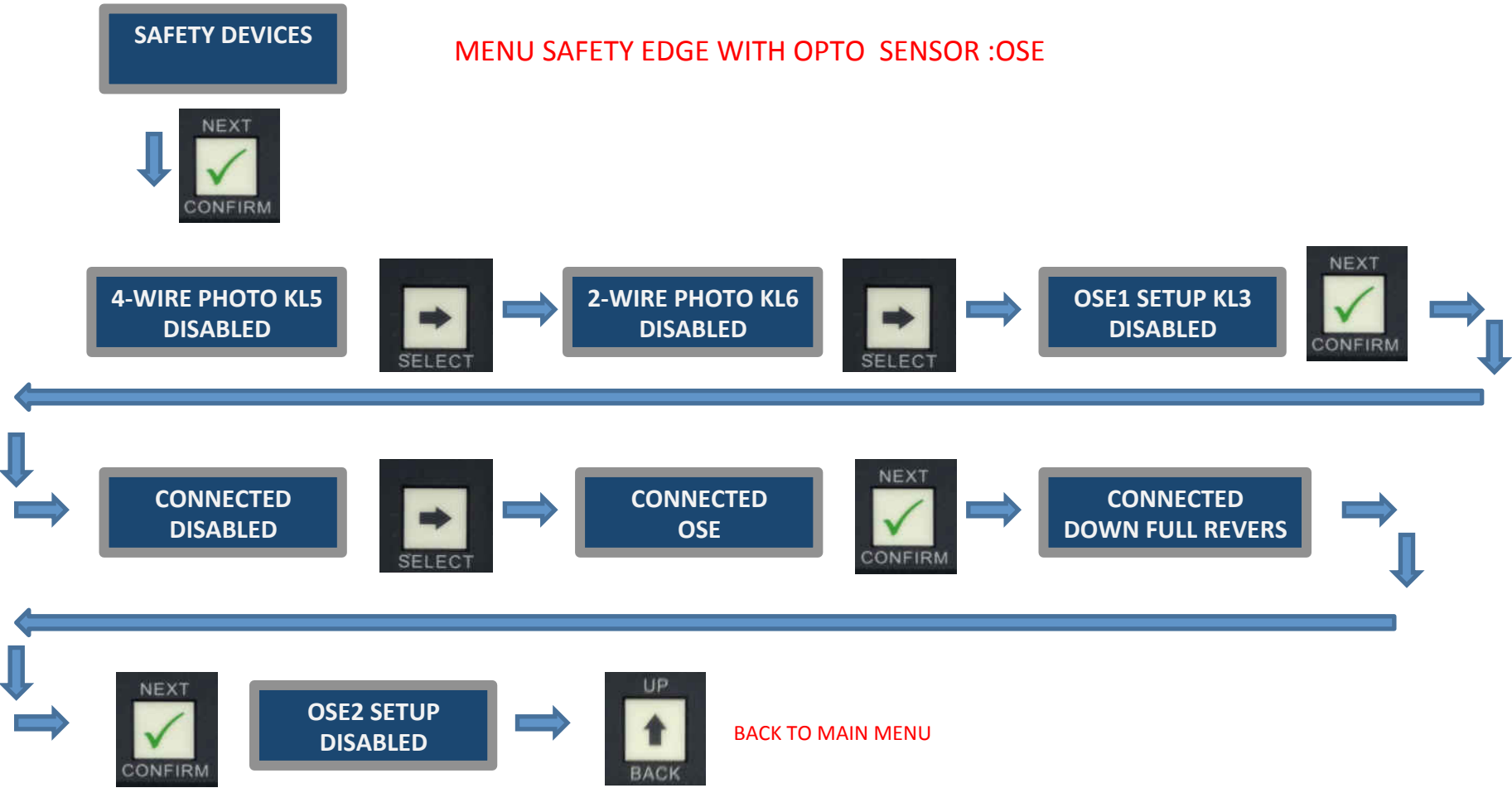

MENU SAFETY EDGE WITH AIR SWITCH

SAFETY DEVICES



4-WIRE PHOTO KL5
DISABLED



2-WIRE PHOTO KL6
DISABLED



OSE1 SETUP KL3
DISABLED



OSE2 SETUP KL4
DISABLED



SAFETY 1 KL2 1-2
DISABLED



CONNECTED
DISABLED



CONNECTED
8K2



CONNECTED
AIR WAVE SWITCH



CONNECTED
DISABLED



CONNECTED
DOWN FULL REVERS

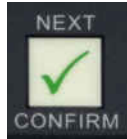

SAFETY 2 KL2 3-4
DISABLED



BACK TO MAIN MENU

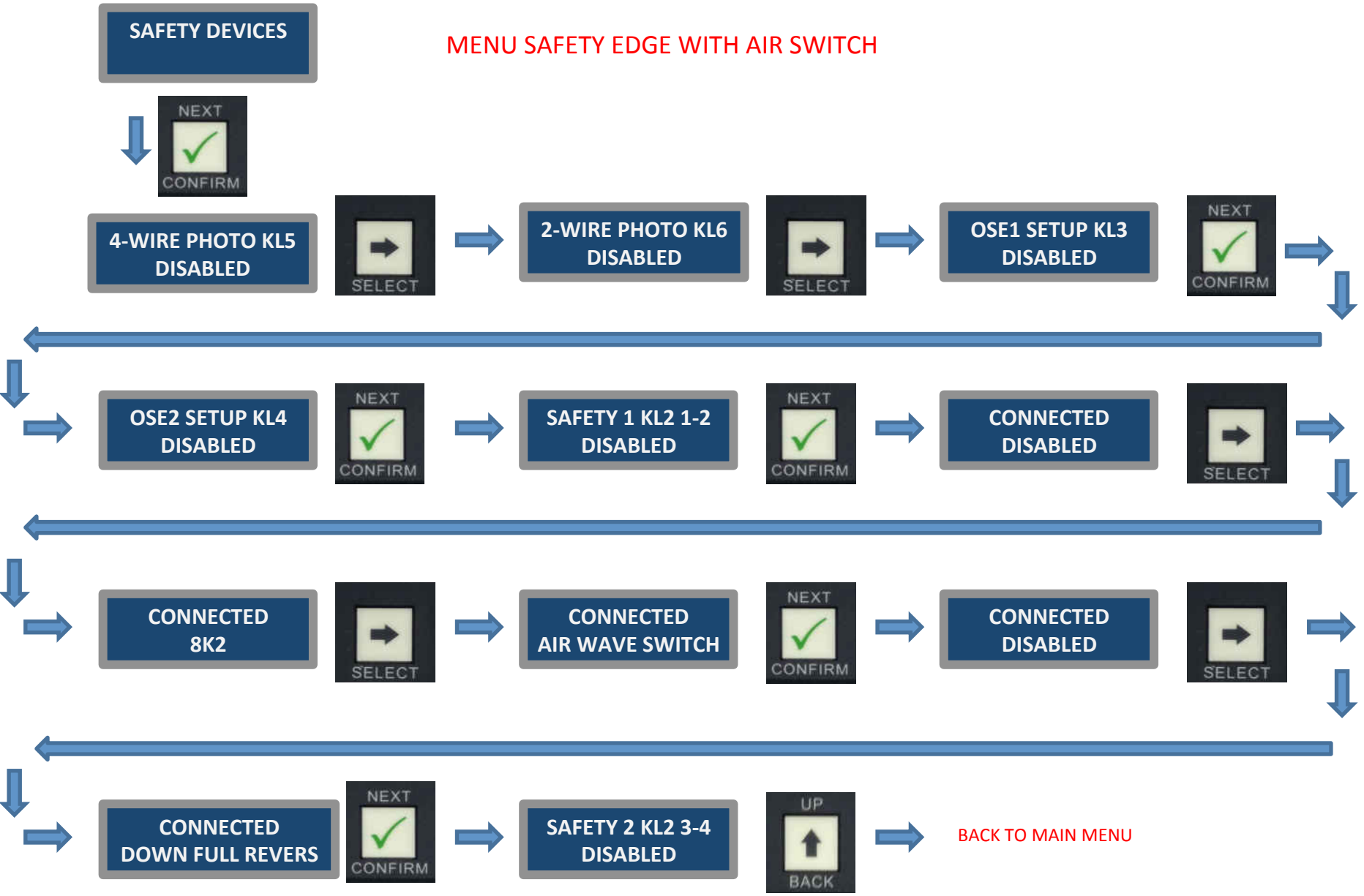

MENU SAFETY EDGE: USING LIGHT CURTAIN

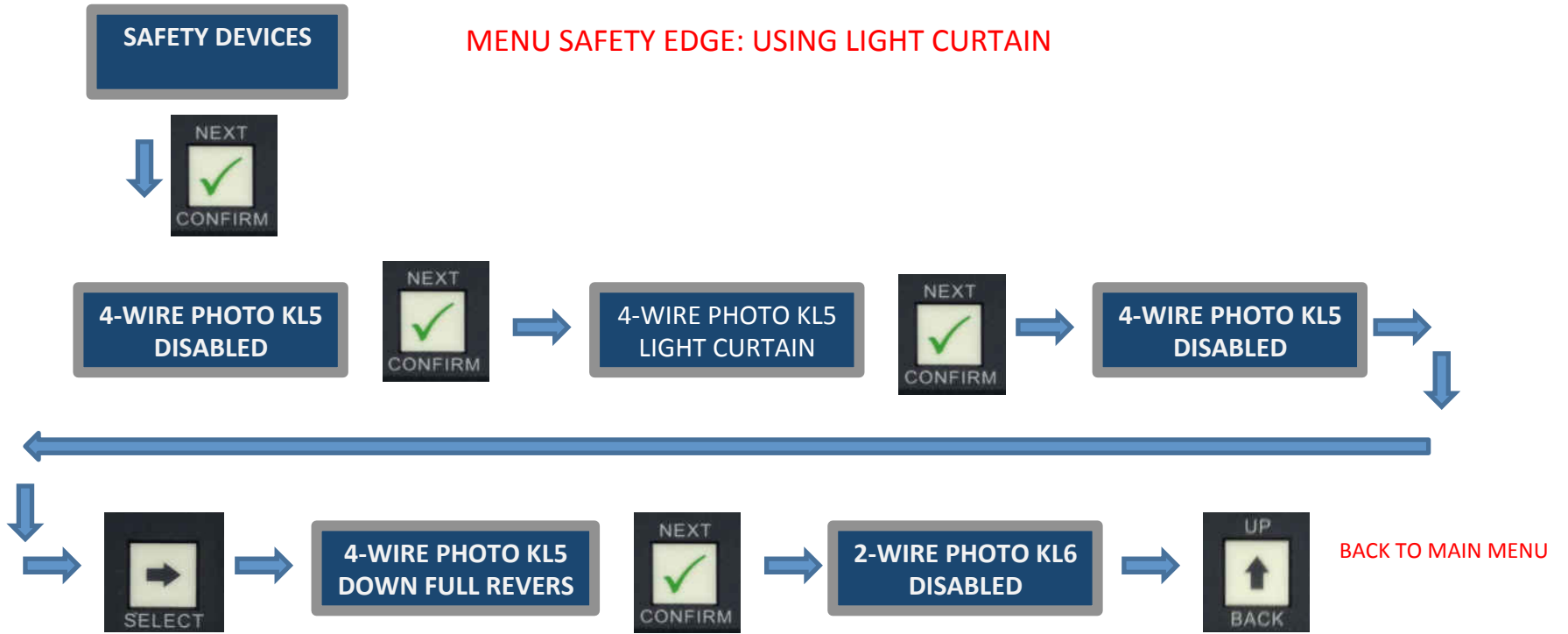

MENU SAFETY DEVICES: USING OSE-IR IN DOORTRACK

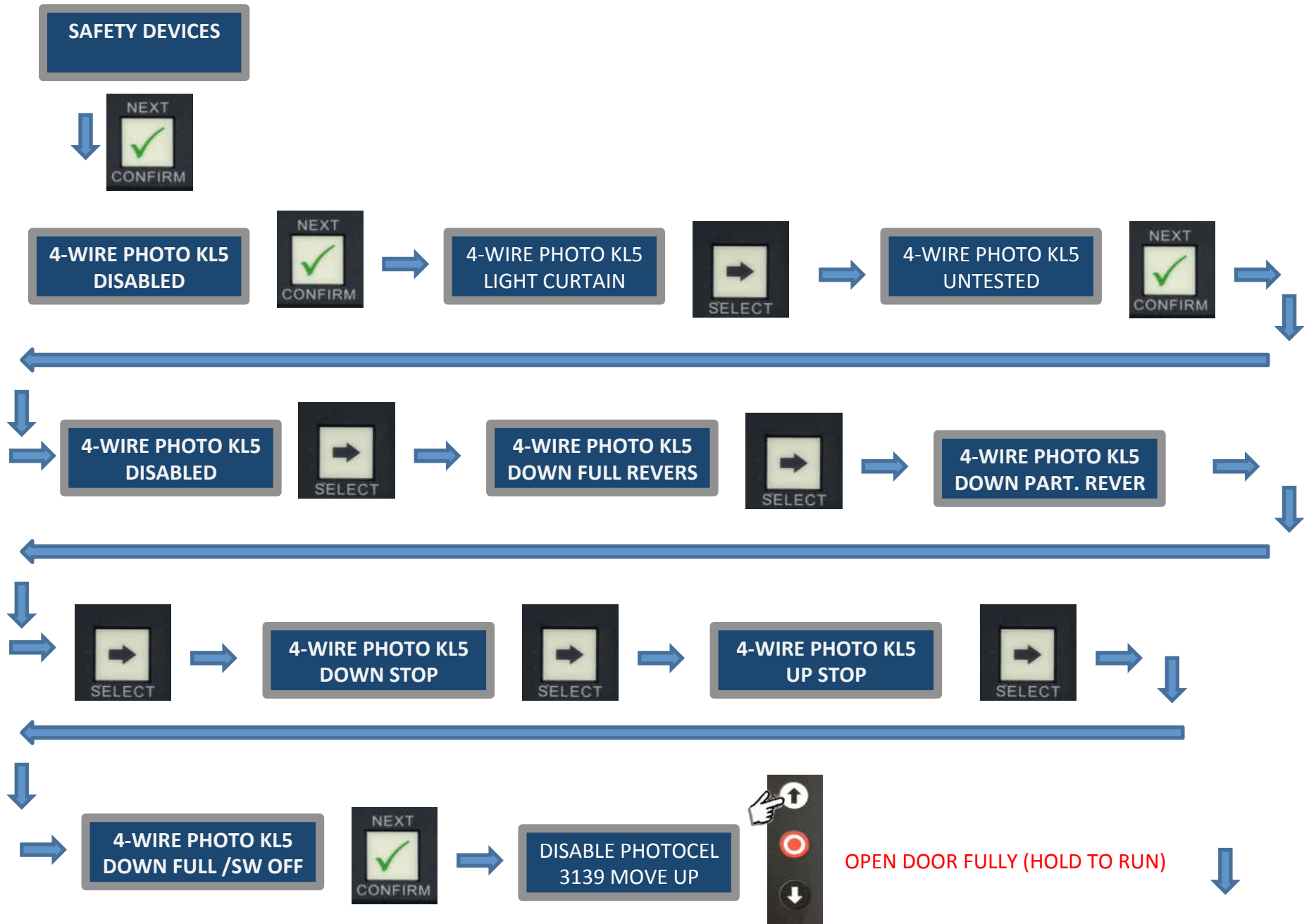

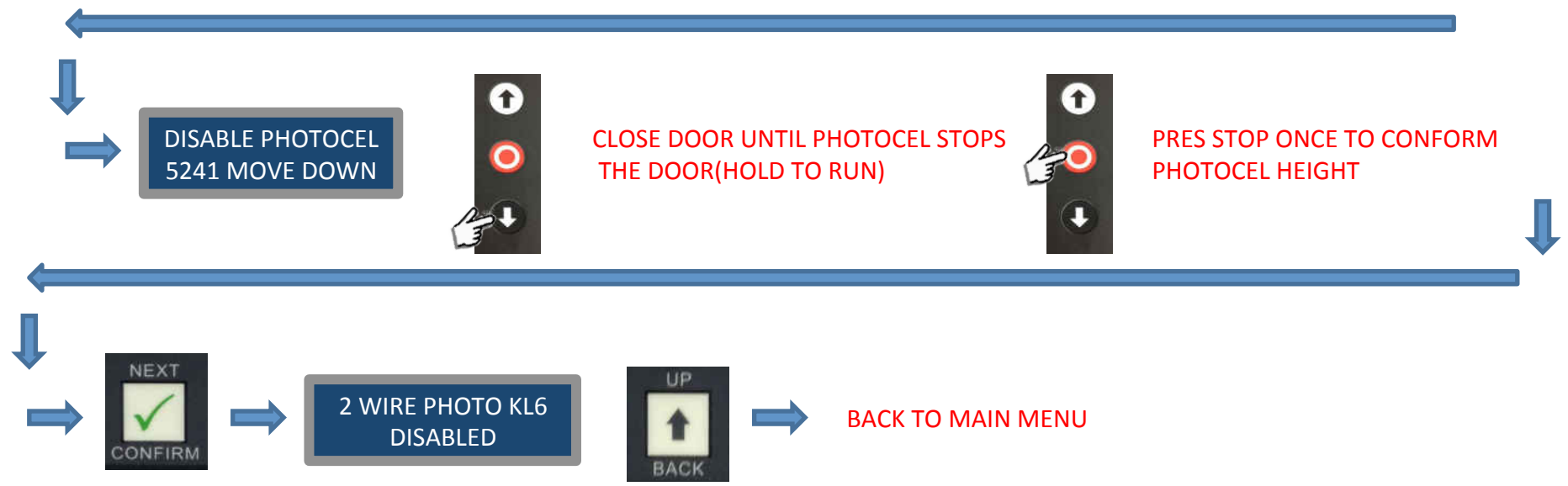

CONNECTIONS OSE-IR TO FORCE IQ KL5

TRANSMITTER:	FORCE IQ KL5:	FUNCTION:
BROWN AND BLACK	TERMINAL 1	+ 24VOLT
BLEU	TERMINAL 4	GND
RECEIVER:		
BROWN	TERMINAL 1	+24VOLT
BLEU	TERMINAL 4	GND
YELLOW	TERMINAL 3	SIGNAL

MENU OPERATING MODE

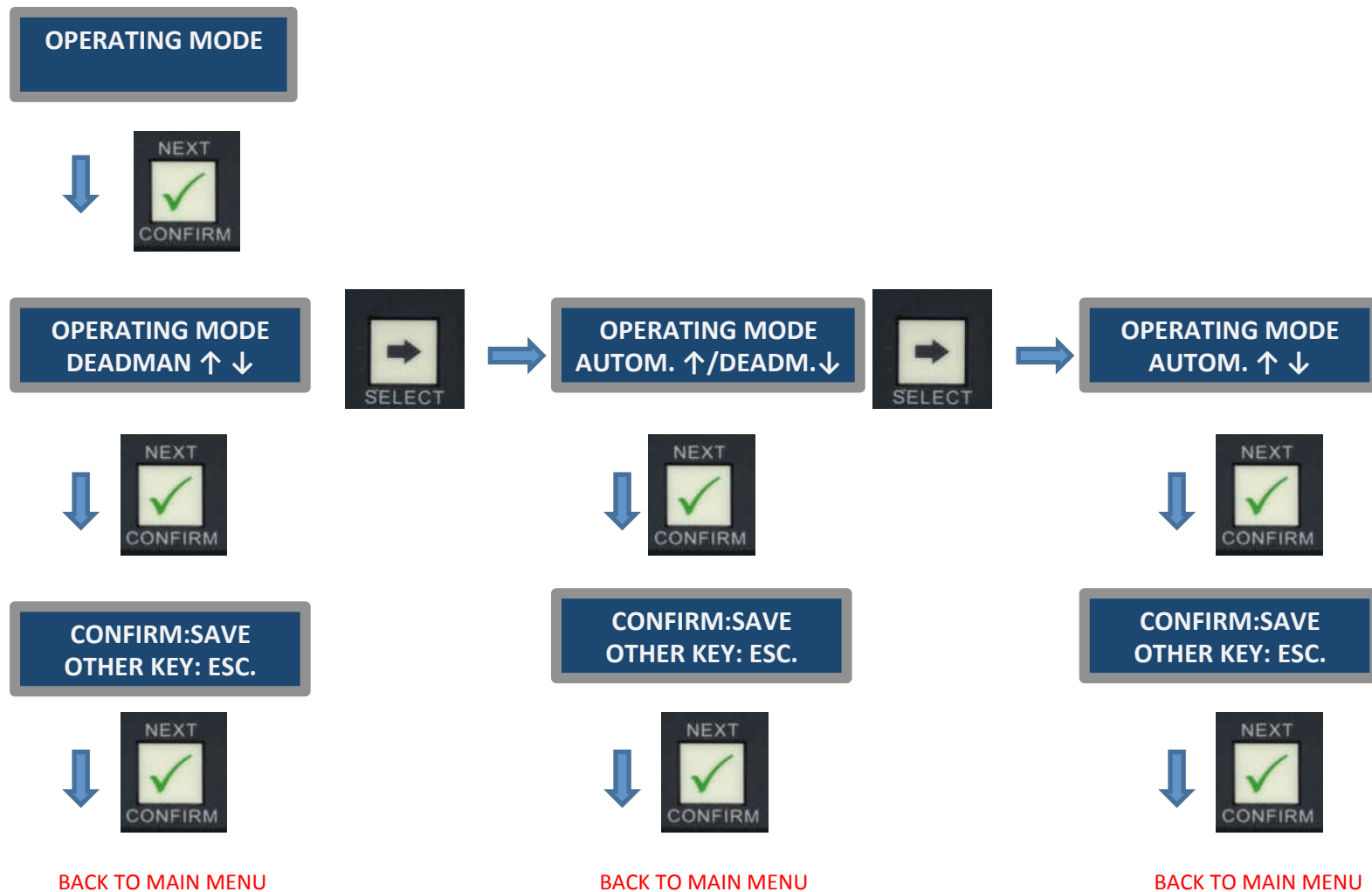

MENU CODE ENTRY= CHANGE ENTRY CODE

IF DESIRED CODE IS 26541 THEN:

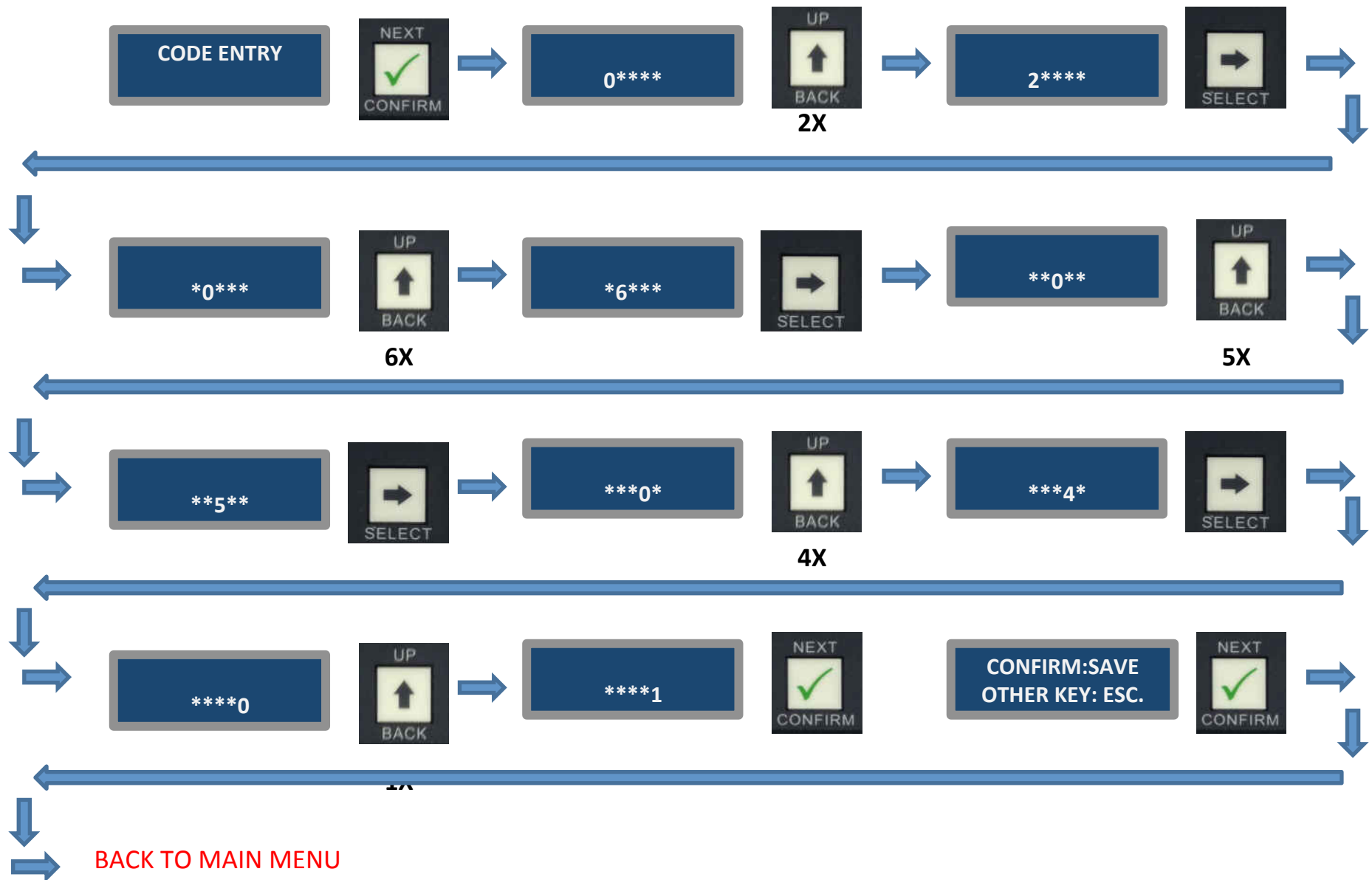

MENU MOTOR SETUP: CHANGE ENCODER DIRECTION

MESSAGE:

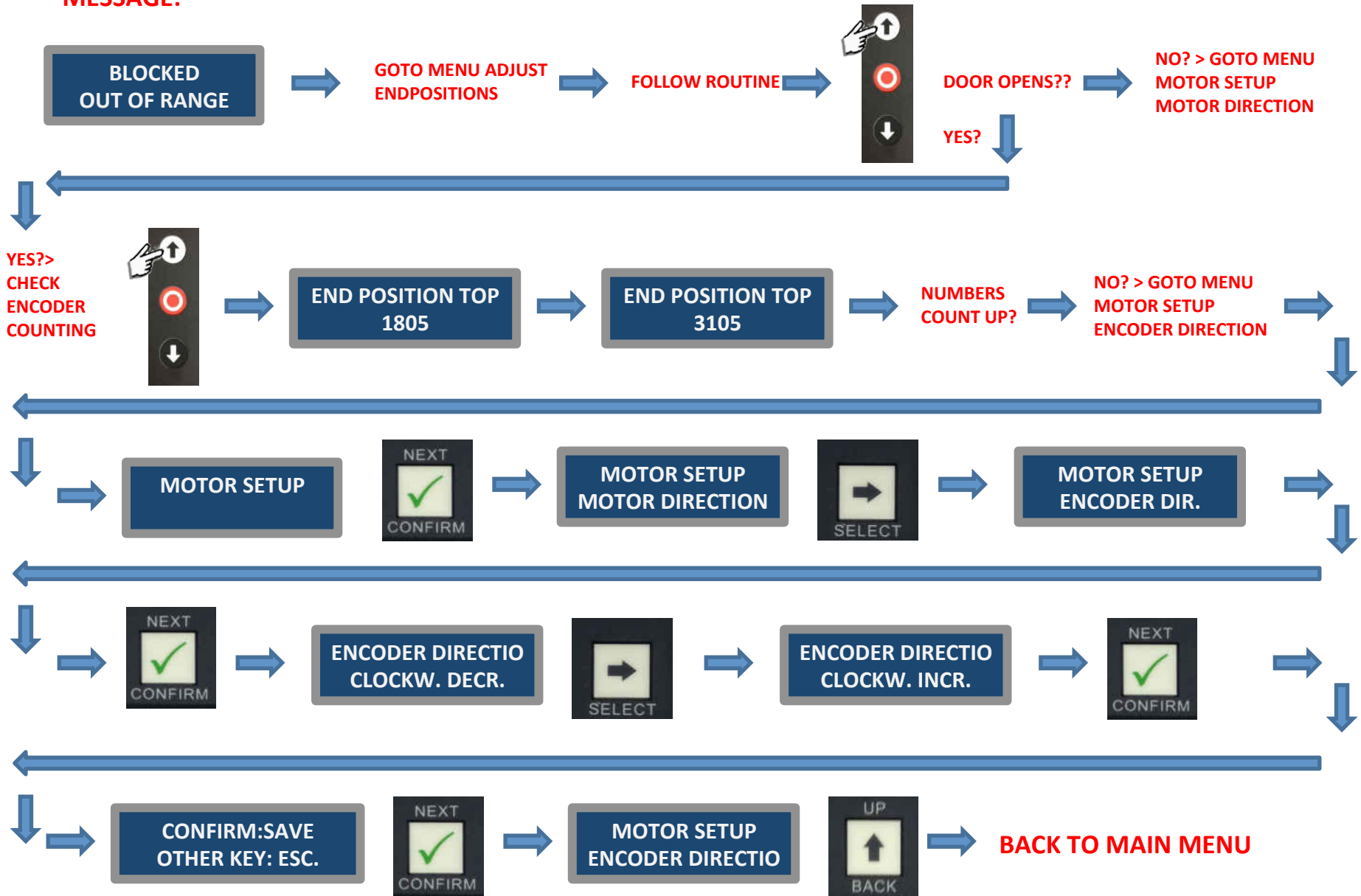

MENU SPECIAL SETUP: SETUP AUTOMATIC CLOSING

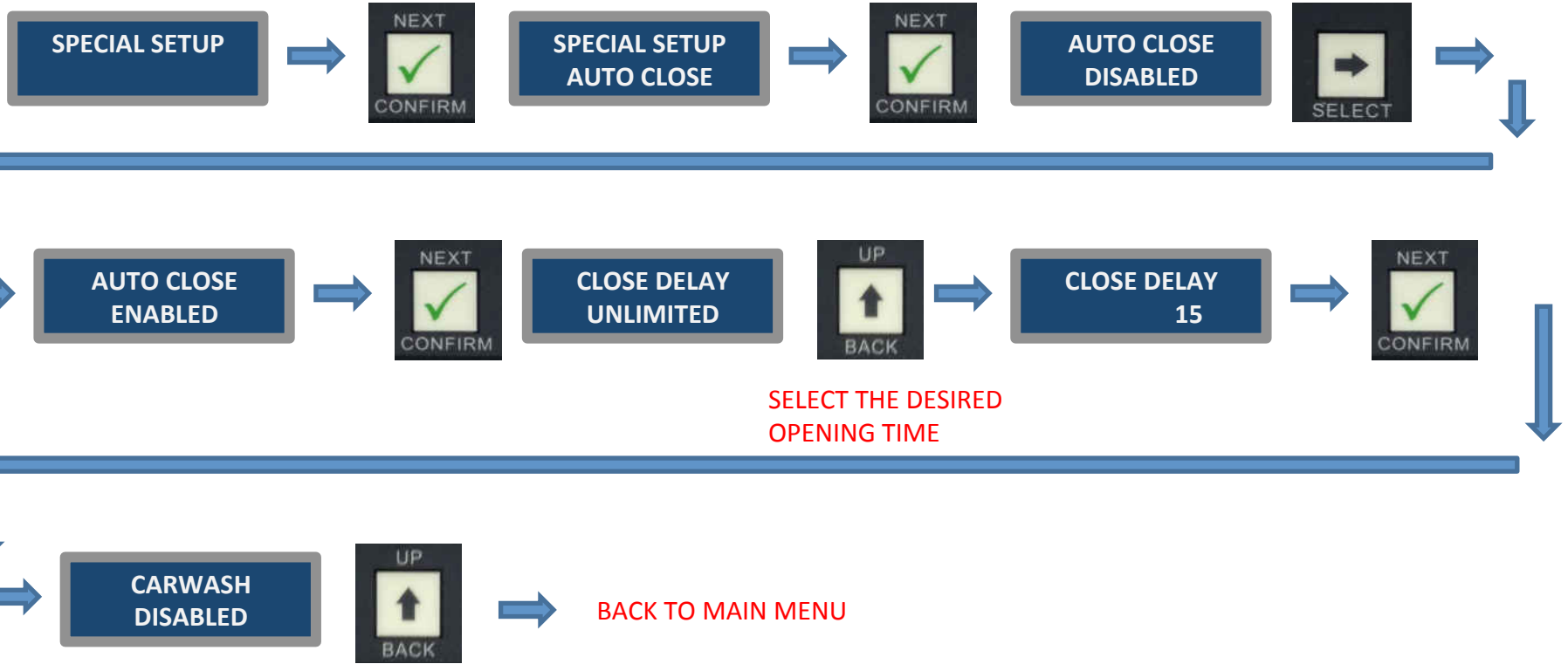

MENU SPECIAL SETTINGS: SET-UP HALF OPEN

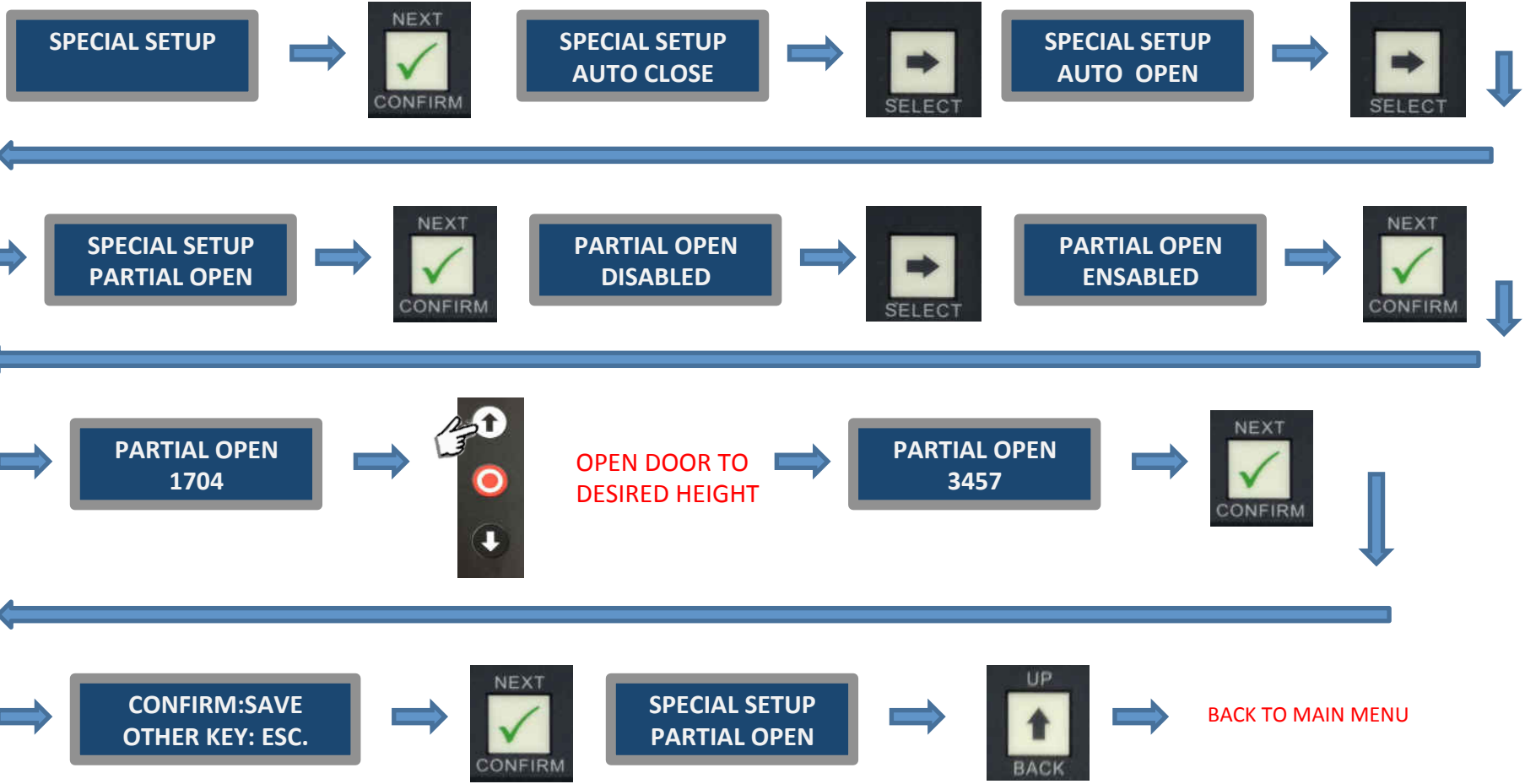

USING ½ OPEN:



2X

DOOR OPENS 1/2



1X

DOOR OPENS FULL

MENU SERVICE / MAIN MENU ITEMS

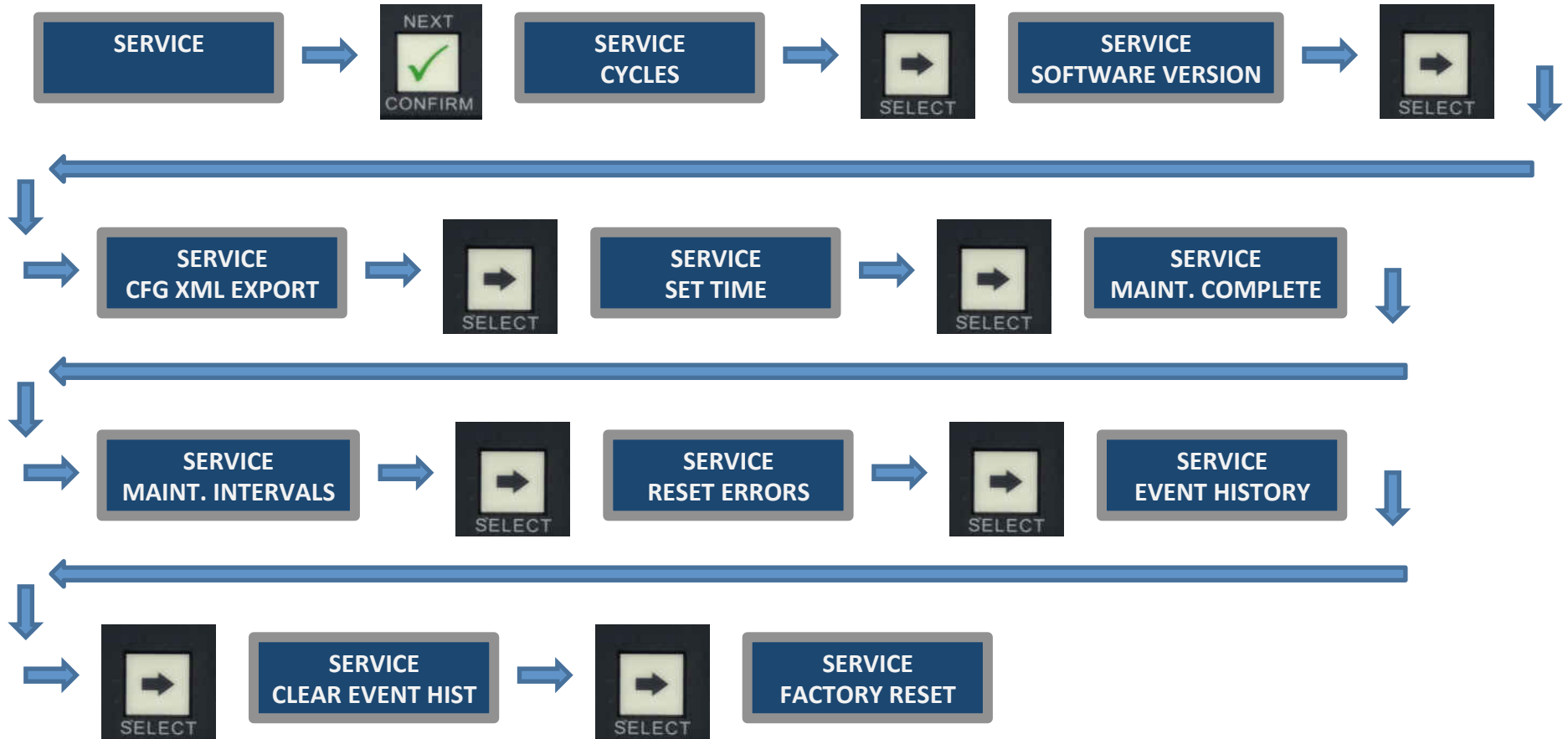

SERVICE SUB MENU CYCLES/DAYS

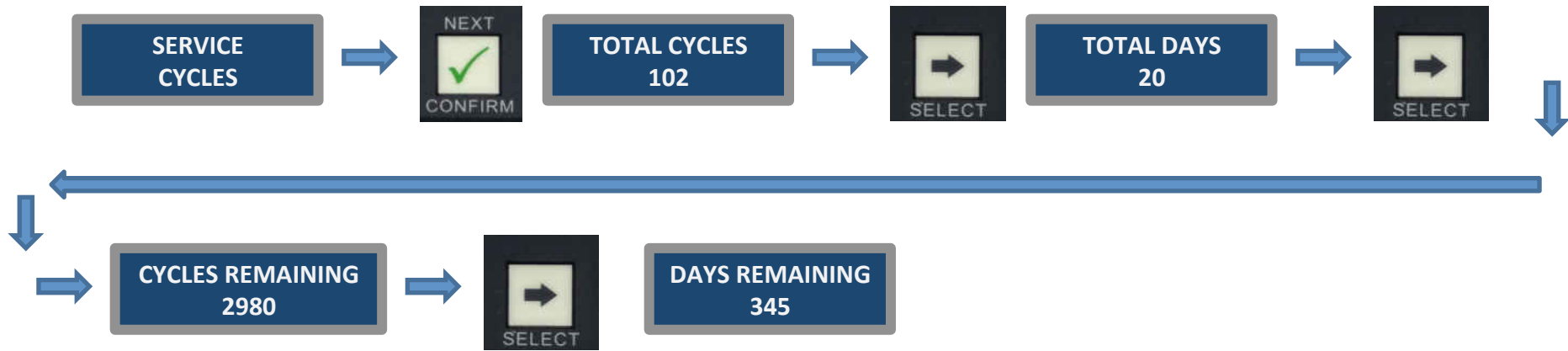

SERVICE SUB MENU SOFTWARE VERSION



SERVICE SUB MENU SET TIME



MANUAL CONNECTING POWER SUPPLY FORCE668LM SLIDE BOLT



Unscrew 4 torxscrews in de ForcelQ control box and put the control board upside down



take the power supply out of the box



Plug the power supply connectors onto the main board (will only fit one way)



Snap the power supply onto the plastic rail of the circuitboard housing



Replace the control box housing in the main control box and tighten the 4 torx screws

Connecting LM668 to Force IQ control box. If lock works the wrong way round then swap KL14 and KL15

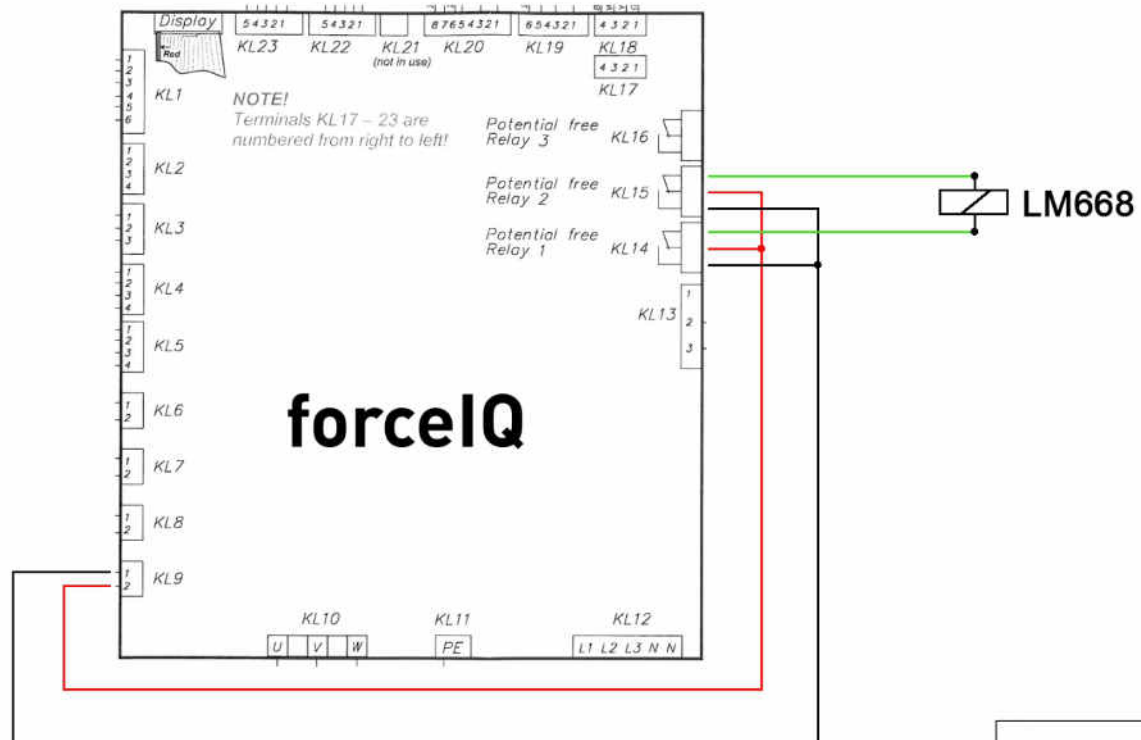

force

Wiring diagram
LM668
www.flexiforce.nl

PROGRAM LOCK 668LM IN FORCE IQ

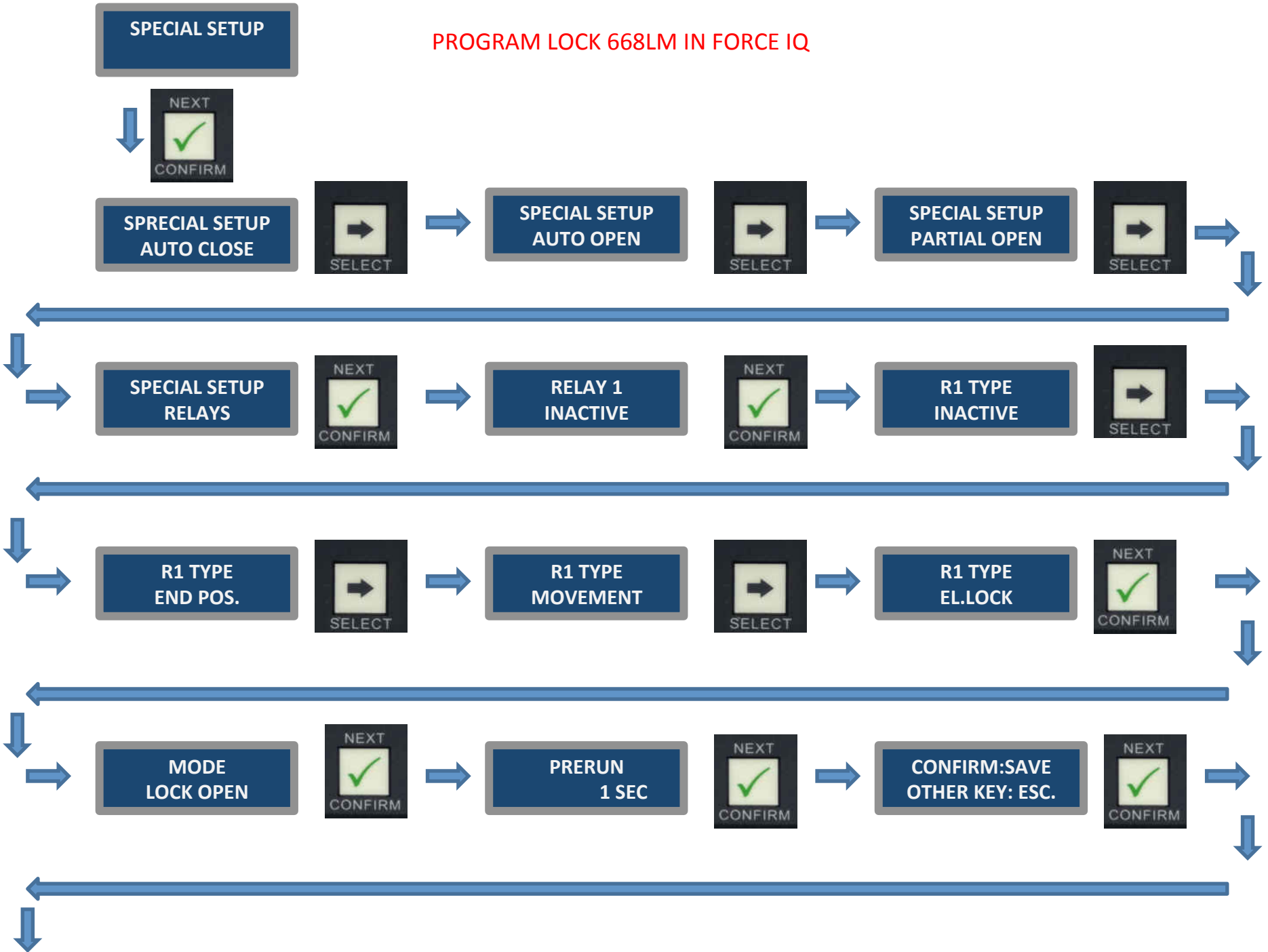

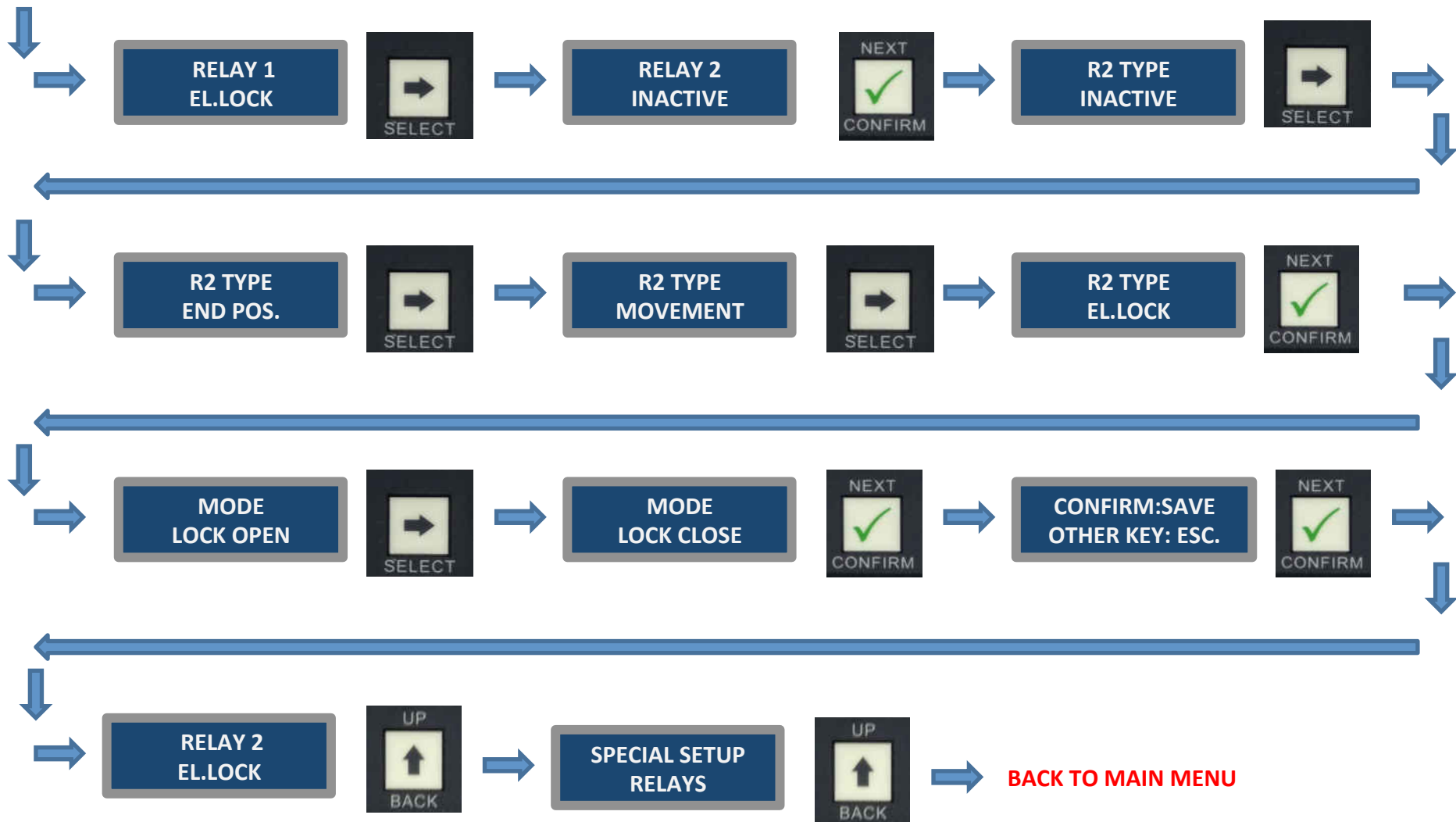

MESSAGE:

**BLOCKED
MOTOR SAFETY**



- 1 CHECK MANUAL RELEASE
- 2 CHECK MOTOR TEMPERATURE
- 3 CHECK (IF CONNECTED) SPRING BREAK DEVICE SWITCHES
- 4 CHECK CABLE CONNECTIONS ON MOTOR AND IN CONTROLBOX

MESSAGE:

**BLOCKED
DOOR SAFETY**



- IF CONNECTED CHECK:
- 1 SLACK CABLES SWITCHES
 - 2 PASS DOOR SWITCH
 - 3 SLIDE BOLT SWITCH
 - 4 EMERGENCY SWITCH
 - 5 SPIRAL CABLE
 - 6 ALL CONNECTIONS
- IF NO OPTIONS CONNECTED CHECK IF TERMINAL KL7 IS BRIDGED

MESSAGE:

**BLOCKED
OUT OF RANGE**



**APPEARS WHEN TRYING TO USE WHEN MOTOR OR
ENCODER DIRECTION IS FAULTY**

**FOR MOTOR DIRECTION GOTO PAGE 9
FOR ENCODER DIRECTION GOTO PAGE 15**

MESSAGE:

**AUTOM UP/DOWN
OSE1 TRIGGERED**

**AUTOM UP/DOWN
8K2 TRIGGERED**

**AUTOM UP/DOWN
4 WIRE PHOT. TRIG.**

**AUTOM UP/DOWN
AIR SWITCH TRIG.**



APPEARS WHEN MENTIONED SAFETY DEVICE IS TRIGGERED

DISAPPEARS WHEN SAFETY DEVICE IS RESTORED

MESSAGE:

AUTOMUP/DEADM
OSE1 DEFECT

AUTOMUP/DEADM
8K2 DEFECT

AUTOMUP/DEADM
4 WIRE PHOT. DEF.

AUTOMUP/DEADM
AIR SW. DEFECT



APPEARS WHEN MENTIONED SAFETY DEVICE IS TRIGGERED LONG TERM OR SELF TEST HAS FAILED

DISAPPEARS WHEN SAFETY DEVICE IS RESTORED/REPAIRED